

# **New PadPlane Connector Locations for the FEE electronics cards**

**August 14<sup>th</sup>, 2015**

- **John Hammond and Bob Scheetz have finished laying out the new padplane**
  - **Many thanks!!**
- **Connector locations for the FEE cards are shifted, slightly, and slots are wider compared to the previous (circa 1995) locations**
- **Changes**
  - **Delete 30 locations from previous total of 55**
  - **Add 3 new locations on the centerline**
  - **New total:  $25 + 3 = 28$**
  - **Connector locations remain the same in one dimension, but in the other dimension they all move down by 0.221”**
    - **“Down” means toward the narrow end of sector**
  - **Slots are to be made wider by 0.225”**

# Old Compared to New

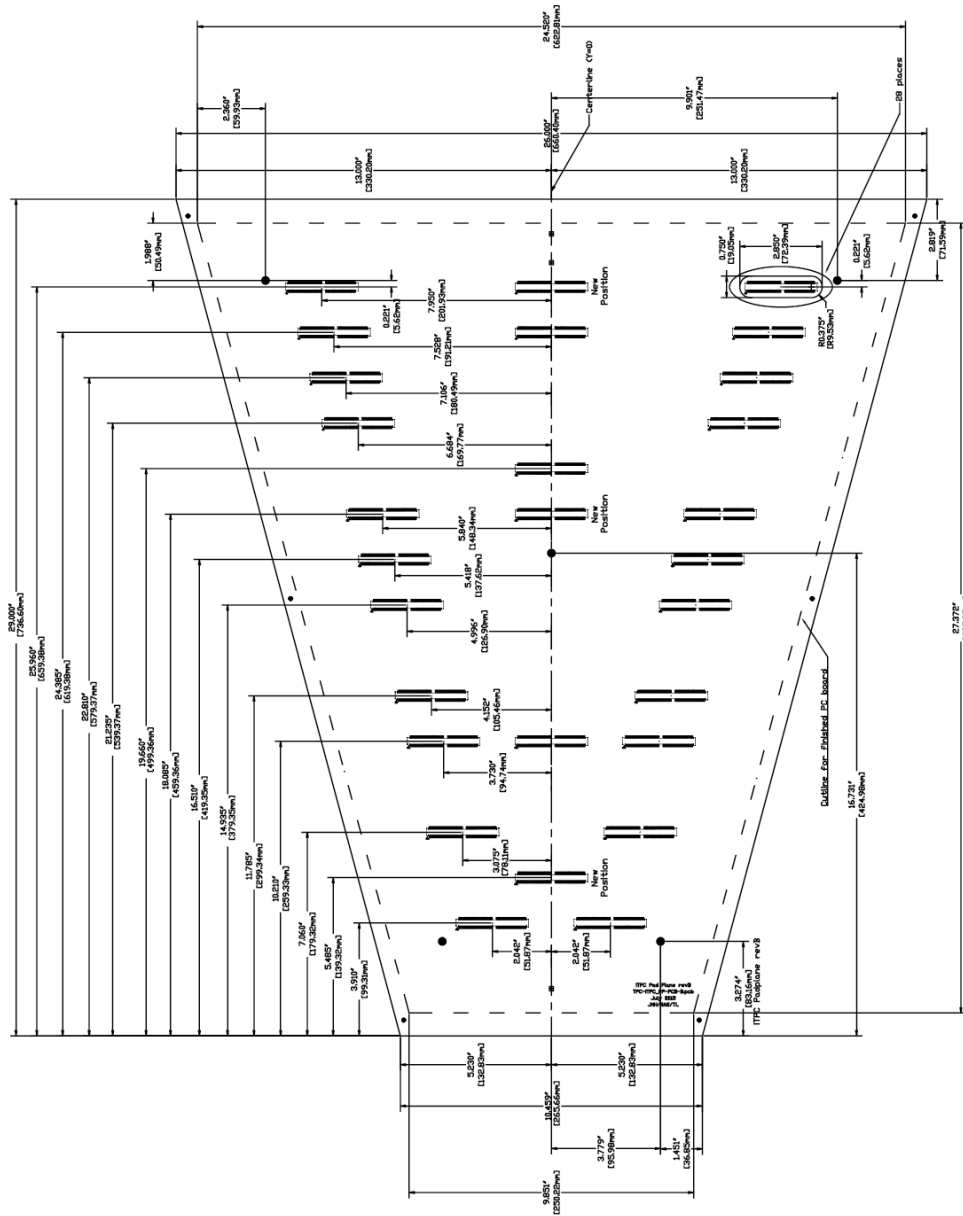
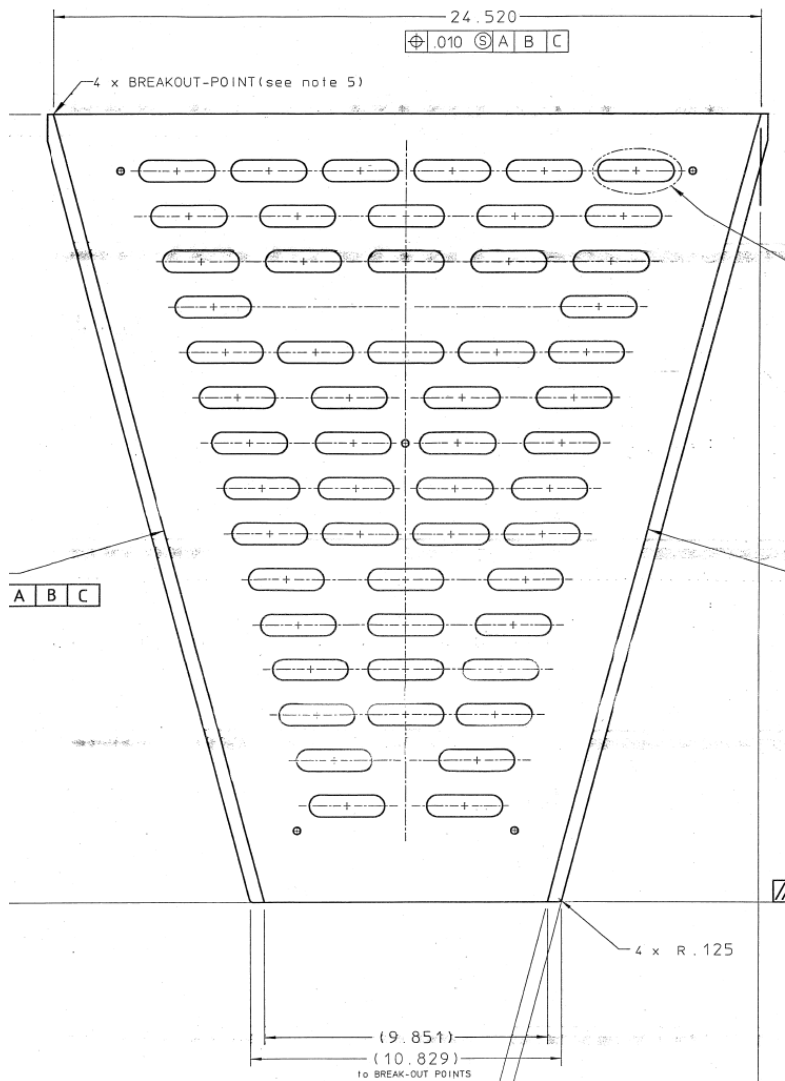



# Add and Delete Slots

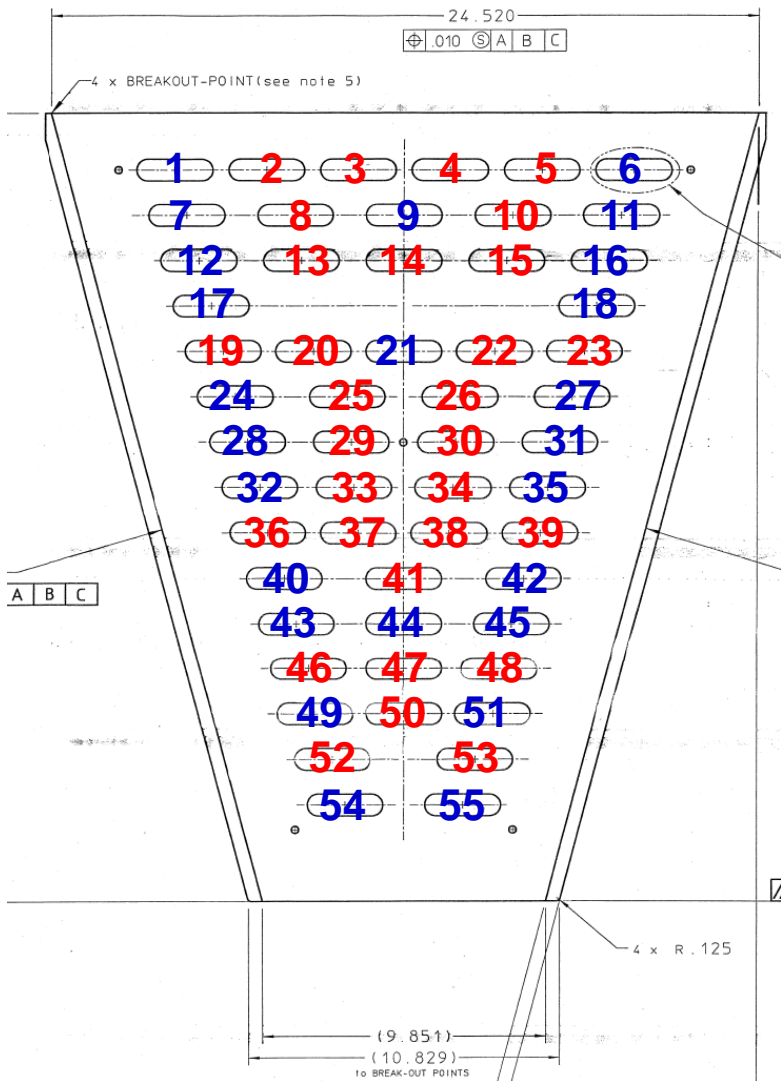

- **Delete**
  - 2, 3, 4, 5
  - 8, 10
  - 13, 14, 15
  - 19, 20, 22, 23
  - 25, 26
  - 29, 30
  - 33, 34
  - 36, 37, 38, 39
  - 41
  - 46, 47, 48
  - 50
  - 52, 53
- Add**
  - 3.5
  - 25.5
  - 52.5

# Shift and Widen Slots

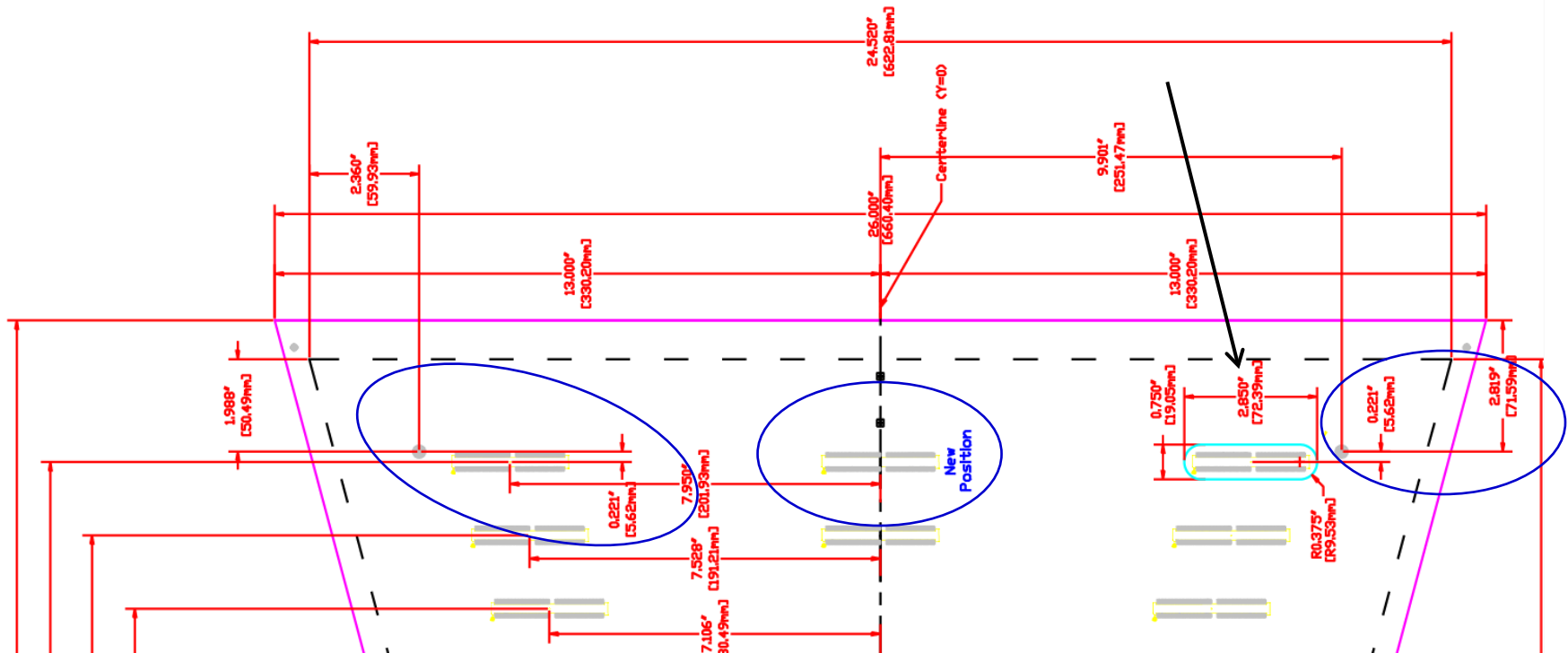

- Horizontal distance from centerline remains the same for all slots
- New slots go on the centerline (3 total)
- All slots (including new slots) are shifted down by 0.221" compared to positions and rows on drawing 24A368D (circa 1995)
- All slots (including new slots) are 0.225" wider (total width = 2.850")

# Slot Detail

## Old Slot Detail from LBL Drawing 24A368D (circa 1995)

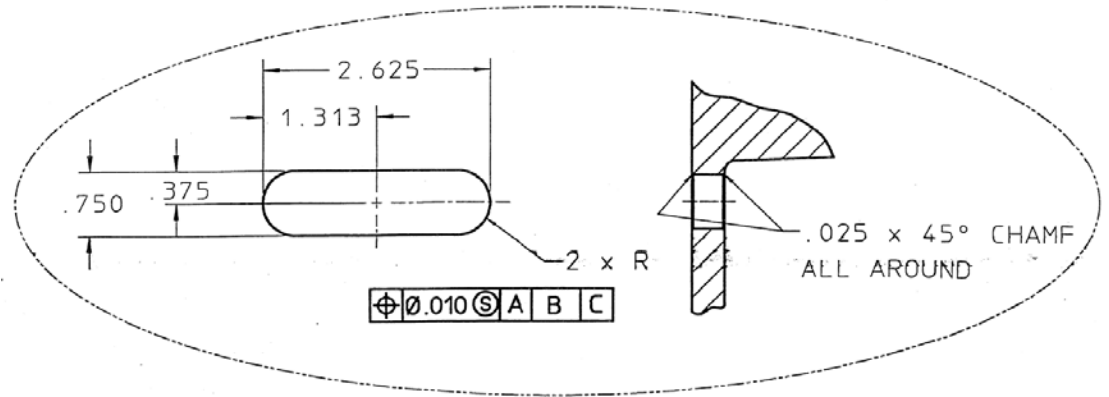

The connectors for the new electronics cards fit in the slots. The old cards used a right angle connector while the new cards will use a card-edge connector which is wider and necessarily shifted down slightly.

## New Slot Detail

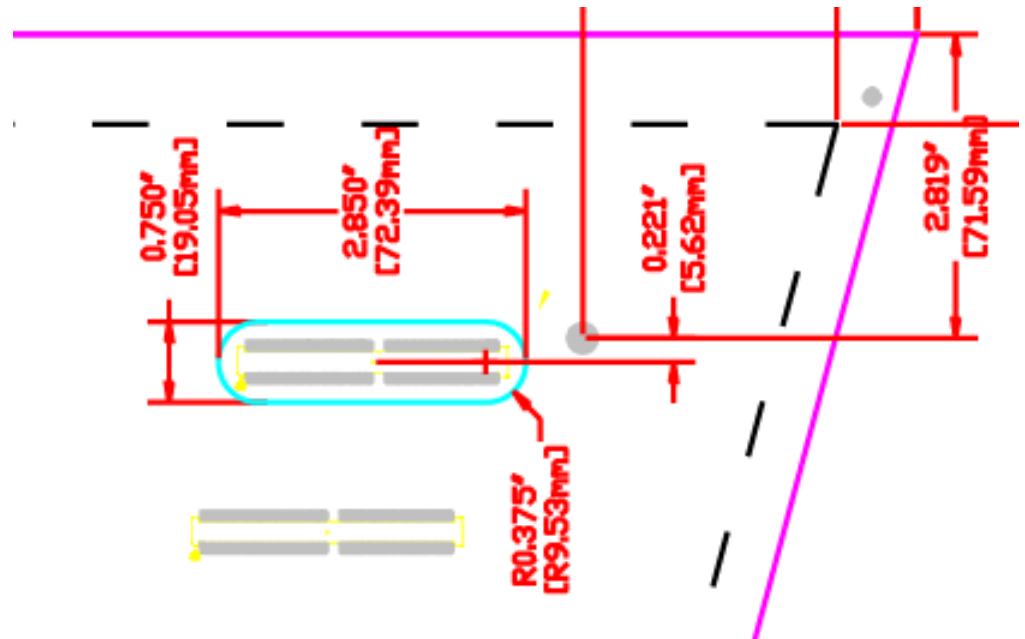

# Connector Locations on the New PadPlane



- Pdf and Dwg drawings available
- <http://rnc.lbl.gov/~jthomas/public/iTPC/PadPlaneProposal/>
- Note that the padplane, as shown here, is larger than the strongback. The strongback outline is shown by the dashed line.

