

New PadPlane Connector Locations for the FEE electronics cards

Note that the August 14th version is obsolete

October 15th, 2015

- **John Hammond and Bob Scheetz have (nearly) finished laying out the new padplane**
 - **Many thanks!!**
- **Connector locations for the FEE cards are shifted, slightly, compared to the previous (circa 1995) locations**
- **Change**
 - **Connector locations remain the same in one dimension, but in the other dimension they all move down by 0.221”**
 - **“Down” means toward the narrow end of sector**

Old Compared to New

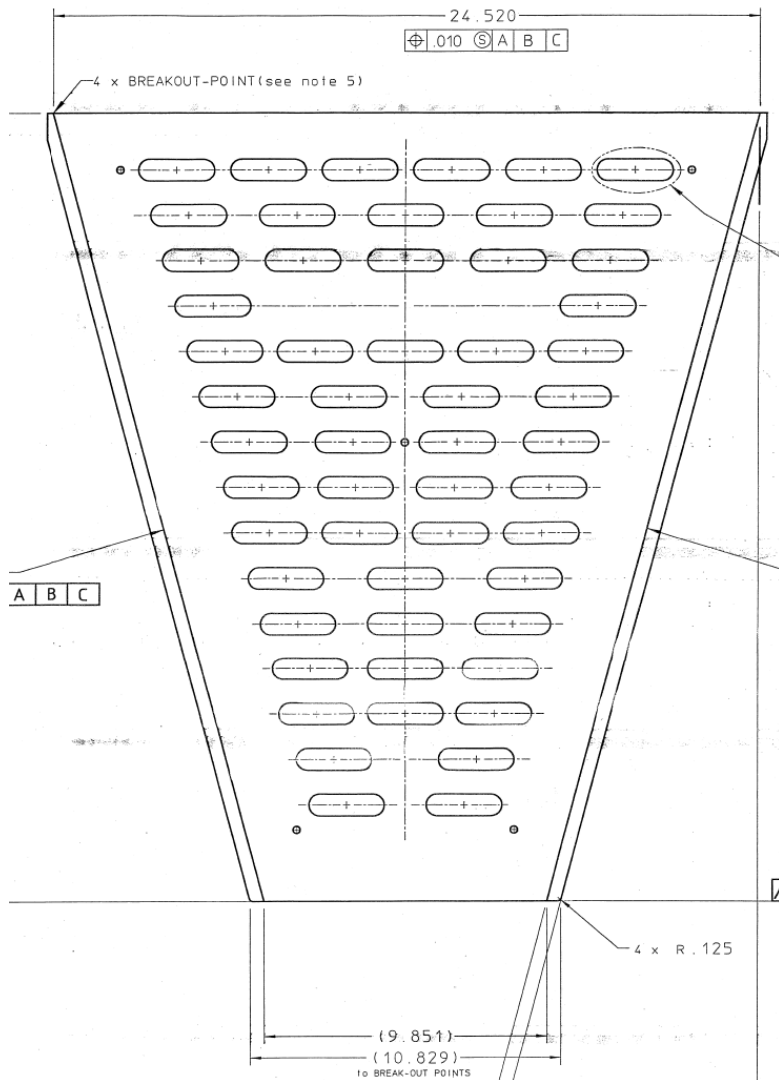

- **55 Slots, same number of slots as before**
- **For all 55 slots, Horizontal distance from centerline remains the same**
- **For all 55 slots, move center of slots down by 0.221”**

Slot Detail

Slot Detail from LBL Drawing 24A368D (circa 1995)

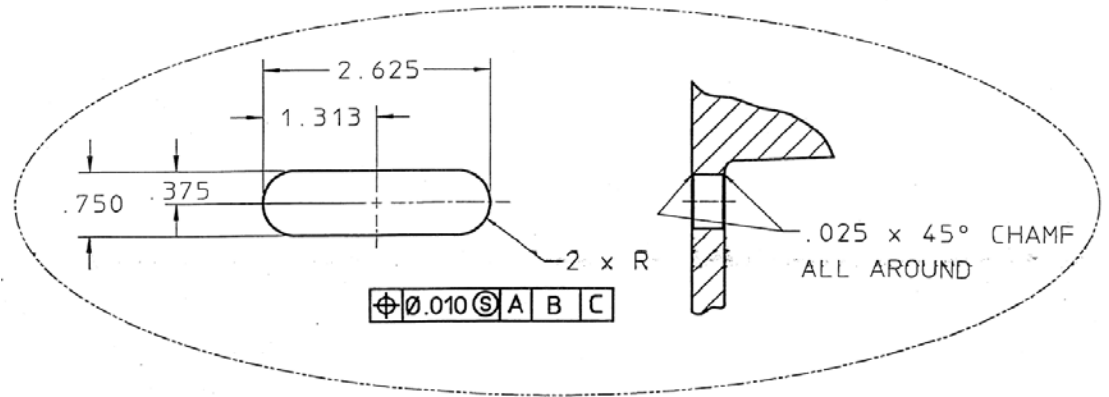

The connectors for the new electronics cards fit in these slots. The old cards had a right angle connector while the new cards will use a card-edge connector. The different style connector means the centerline for the slots must be shifted down slightly.

New Slot Detail

